

REV.	LOCAS.	DESCRIPTION	DATE	DRAWN
01		INITIAL RELEASE.	2007.08.02	

Specifications

- Recommended P.C.Board Hole Layout
- Current Rating: 1Amp
- Insulation Resistance: 1000M Min.
- Dielectric Withstanding: 300V AC
- Contact Resistance: 20mΩ Max.
- Operating Temperature: -40°C to +105°C
- Materials
- Contact Material: Phosphor Bronze
- Insulation Material: Polyester, UL 94V-0 Nylon-6T
- All materials must be GP materials

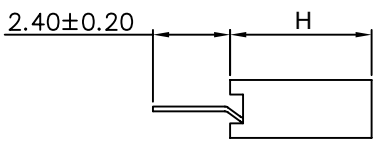
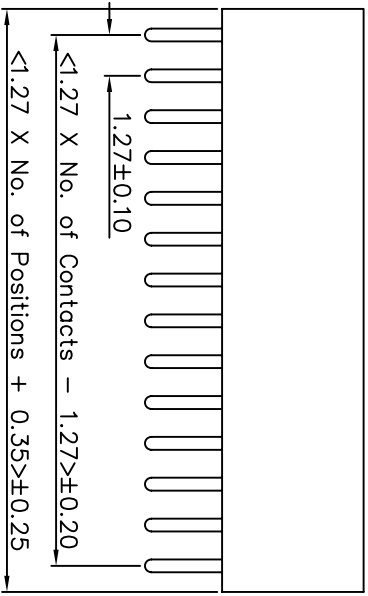
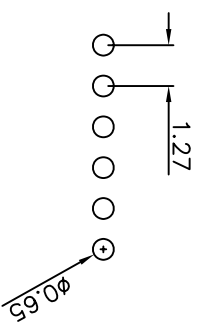
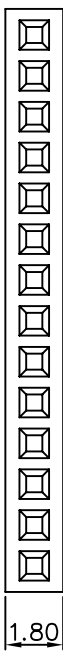

REV.	UNIT.	SCALE.	PAGE.		GENERAL TOLERANCE		DESIGN:	DATE:	Part Number:	TITLE:
					X. ± 5°	X. ± 0.30	CHECKED:	DATE:	SM C02 4832 XX S H=YYmm	1.27 FEMALE HEADER
01	mm	3:1	1/1		X. ± 2°	X. ± 0.20	AUDITED:	DATE:	XX: Number of Poles	SINGLE ROW DIP TYPE
					.XX* ± 1°	.XX ± 0.15	APPROVED:	DATE:	YY: Plastic Height (3.4 / 4.3 / 5.7mm)	
					.XXX ± 0.5°	.XXX ± 0.10				



A

B

C

D

E

F

A

B

C

D

E

F